

## 1-channel Dimmer TVDMM868A01

### Attention

The subject appliance must be installed only by qualified technical personnel in compliance with the standards. All connections must be rated for a single-phase power supply of 230V. For the disconnection from the power line, use an all-pole switch with contact with an opening of at least 3,5mm. Only suitable materials for the connections must be used to guarantee insulation that complies with current standards on the subject of electrical safety. All the necessary safety devices are to be seen to separately.

### 1- Description

Dimmer for the manual or radio control of the loads "R,L" (resistive, inductive) up to max. 500W. Module of 4 elements for Din rail mounting.

**Attention:** It is not possible to dimm electronic transformers which are note explicitly marked with the words "dimmable with triac-dimmer".

Possibility of the following functions:

- Memory last level of luminosity intensity.
- "Stairs" function (for the lighting of stairs) with adjustable time from 1 to 9 minutes.
- Possibility to change the "stairs" time from transmitter or manual pushbutton, indication of the current settings by means of the variation of the load luminosity.
- Dynamic control via radio with transmitter up to 4 channels.
- Control of the pre-settled scenes with 7-channel transmitter.
- Possibility to memorise up to 4 scenes for each transmitter.
- Possibility to change in each moment the chosen scene.
- Memorisation via radio of a new transmitter (without accessing the receiver).
- Delete via radio of a transmitter or a channel without accessing the receiver.
- Possibility to memorise up to 16 transmitters.
- Led for signalisation of the setting and verification of faults.
- Acoustic (buzzer) indication of memorisation and delete operation.

### 2- Connections referred to the general power supply 230V ~

- Normally opened input for manual pushbutton.
- Input for general power supply 230 V ~ .
- Output for 230 V ~ 500 W load.

### Loads which can be connected :



Halogen lamps



Toroidal transformers



Dimmable electronic transformers



Laminated transformers

### Device protection with:

- 3,15 A fuse.
- Internal thermic with auto-reset.
- Electronic control of the load status.

### 3- Device pushbuttons:

- P1: Manual control pushbutton for load functioning test.
- P2: Pushbutton for 7-channel transmitters memorisation (or reset LED3).
- P3: Pushbutton for memorisation of standard transmitters up to 4 channels (or reset LED3).

### Pushbuttons combinations:

- P1 + P3: Activation or deactivation of last setting memory function.
- P2 + P3: Activation or deactivation of "stairs" light function.
- P1 + P2: Programmation for the modification of the scene.

### 4- LED indication

- LED 1: "Stairs" function active.
- LED 2: Receiving of a radio signal.
- LED 3 : Indicates a malfunction (fault fuse, interrupted load, internal fault).
- LED 4: Active memory function.

### 5- Activation-deactivation memory function (light memory)

Memory function activated: by controlling the load in ON/OFF mode, the memory function adjusts at the turning-on the luminosity on the last settled value.

The memory function is deactivated by using the 7-channel transmitter. The memory function is deactivated with the "stairs" light function.

Memory function deactivated: the light turn on at the maximum value.

Activation-deactivation memory function: press at the same time the push buttons P1 + P3, the LED 4 will commutate its status.

The dimmer receiver of default gets out with memory function in OFF.

### 6- Input manual pushbutton for light adjusting

Short impulse (< 400mS) = ON/OFF

Long impulse (> 400mS) = adjusting upgrade or downgrade.

Attention: when it arrives on max. or min. it will stop (time range 7 sec.)

### 7- "Stairs" function

This function is used for the lighting of stairs.

This function permits, by means of a pus button, to activate a circle of illumination, which remains until the maturity of a time (tp) settled by the user.

Activated only by remote pushbutton or standard transmitters.

Description:

- switched-off light;
- press remote pushbutton or from standard transmitter briefly;
- the light will turn on at the maximum for a time tp (default = 1min);
- after tp the light will lowered down to 30% in 15 sec.;
- after another 15 sec. the light turns off.

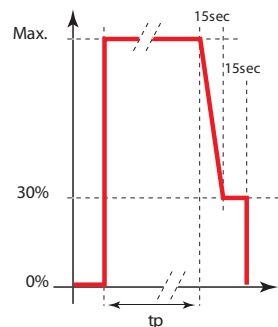

### 7.1- Activation- deactivation "stairs" light function

Press at the same time the two pushbuttons P2 + P3 until the relative LED1 commutates.

### 7.2- Adjusting of "stairs" light time

- Press within 5 seconds for five times the remote pushbutton or the pushbutton of the standard transmitter;
- After 5 sec. the light will lowered down to 50 % of the maximum value;
- Within 10 sec. press n times to select the following tp values:

n= 0 tp= 1min

n= 1 tp= 1min

n= 2 tp= 3min

n= 3 tp= 5min

n= 4 tp= 7min

n= 5 tp= 9min

At every increase the buzzer will sound.

- After the 10 sec. the receiver will turn off and will return to the normal functioning.

### 8- Memorisation standard transmitter channels (memorisation from receiver)

**ATTENTION: The first transmitter can only be memorized using the receiver.**

### 8.1- Memorisation single channel

The channels ch1,ch2,ch3,ch4 will be memorised one by one and have only the adjusting luminosity function with the standard sequence:

Short impulses control ON/OFF of the load, longer impulses regulate the intensity.

1- Press and hold down the pushbutton P3 of the receiver, the buzzer will sound continuously.

2- Transmit the channel which is to be memorised, once the channel is memorised, the buzzer will sound intermittently, release the pushbutton.

Repeat points 1 and 2 to memorise ulterior channels from receiver.

See paragraph 10 to memorise ulterior channels from transmitter.

### 8.1- Memorisation couple of channels

The channels ch1,ch2 and ch3,ch4 will be memorised in couple and have only ON/OFF function at the load.

- 1- Press two times and hold down the pushbutton P3 of the receiver, the buzzer will sound continuously.
- 2- Transmit one of the couple of channel which is to be memorised, once the channel is memorised, the buzzer will sound intermittently, release the pushbutton.

Repeat points 1 and 2 to memorise ulterior channels from receiver.  
See paragraph 10 to memorise ulterior channels from transmitter.

### 9- Memorisation of particular transmitters with 7-channels

By memorising only one channel, the other channels will be also activated with a different procedure (pushbutton P2 restricted).

With the "stairs" function activated, the 7-channel transmitters are deactivated, they will not turn on the dimmer.

- 1- Press and hold down the pushbutton P2, the buzzer will sound continuously.
- 2- Transmit one of the channels A-B-C-D of the transmitter which is to be memorised, once the channel is memorised, the buzzer will sound intermittently, release the pushbutton.

Repeat points 1 and 2 to memorise ulterior channels.

The memorised transmitter will have of default the following settings of scenes:

- Pushbutton A: Luminosity at maximum
- Pushbutton B: Luminosity at 75%
- Pushbutton C: Luminosity at 50%
- Pushbutton D: Luminosity at the minimum.
- Pushbutton OFF: Switches off the light.

### 9.1- Change the level of light intensity of the scenes

#### Case 1:

- press the pushbutton of the scene which is to be modified, the load will turn on at its value;
- adjust the new value with the two pushbuttons ▲ ▼ ;
- hold down the OFF pushbutton for 5 sec., during this time the load will turn off;
- after 5 sec. the buzzer of the receiver will sound for 5 sec. and the load will turn on at the new value.

#### Case 2: (more receivers have memorised the same 7-channel transmitter)

In the case that more receivers have memorised the same 7-channel transmitter, and you want to programme in some receivers a different value for the same scene, you can vary in every receiver the delay after that it is possible to adjust the new value (point 2).

- 1- Press one of the pushbuttons A-B-C-D for 5 sec., all load will be turn on at their value and the buzzer will sound for 4 sec;
- 2- Wait for the turning-off of the load which has to be modified (delay). When it turns off (in this moment the receiver is ready to adjust the new value) press within 4 sec. the push button relative to the scene which has to be modified and adjust the new value with the two pushbuttons ▲ ▼ ;
- 3- Press the pushbutton OFF;
- 4- The buzzer of the receiver will sound for 5 sec.

To vary the delay:

- 1- Press at the same time the pushbuttons P1 and P2 of the receiver, the LED2 turns on.
  - 2- Increase the delay of the time with the pushbutton P3 or decrease with P2. Each variation is equal to 4 seconds and is signalised by a short turning-off of the LED2. At the minimum (4 sec.) or maximum (120 sec.) adjustment the LED2 remains turned-on.
  - 3- Press the pushbutton P1 to memorise and escape; the receiver will sound a bip and the load turns on.
- Default of delay: adjusted at 4 sec.

### 10- Memorisation standard transmitter channels from transmitter (ulterior transmitter)

The type of memorisation of the channels (single, couple or 7-channel) depends on how the channel, which is used in point 2, has been memorized.

- 1- Press and hold down the pushbutton P3 of the transmitter, the buzzer will sound continuously.
- 2- Transmit a channel present in the memory of the receiver, in which the new code is to be memorized, within 5 seconds and the buzzer will interrupt the sound for 1 sec, and then carry on for another 5 seconds.
- 3- Transmit the channel which is to be memorised, once the channel is memorised, the buzzer will sound intermittently, release the pushbutton.

Repeat points 1-2 and 3 to memorise ulterior channels.

### 11. Delete of a single channel or transmitter from receiver

- 1- Press two times and hold down P2, the buzzer will sound with slow intervals.
  - 2- Transmit the channel or transmitter which is to be cancelled, once it is cancelled the buzzer will sound continuously.
- Repeat points 1 and 2 to cancel ulterior channels.

#### 11.1. Delete of all memorised codes from receiver

- 1- Press three times and hold down P2, the buzzer will sound with quick intervals.
- 2- Hold down the pushbutton, once it is cancelled after 10 sec. the buzzer will sound continuously.

#### 11.2- To cancel via radio a code through a transmitter already set in the memory

- 1) Press P3 of the transmitter for three times at regular intervals within 5 seconds, buzzer will sound intermittently slowly.
  - 2) Transmit the code which is to be cancelled within 5 seconds, once the code has been cancelled buzzer will sound continuously.
- To cancel ulterior codes repeat points 1 and 2

### 12. TVLINK compatibility

The dimmer will be memorised on the TVLINK like a normal receiver, in each device you can find the TVLINK code which is to be inserted.

The commands are sent in the following way:

- Close: works as control of turning off.
- Open: works as ON/OFF command if used in impulsive function, or in dimmering command if hold down for longer time.

The receiver works with all transmitters of the TVLINK series.

### 13. Technical specifications

- Power supply 230 V ~ 50 Hz
- Minimum adjustable load 25 W
- Maximum adjustable load 500 W
- Load type R,L
- Frequency radio part 868.3 MHz
- Modulation FSK

In the view of a constant development of their products, the manufacturer reserves the right for changing technical data and features without prior notice.

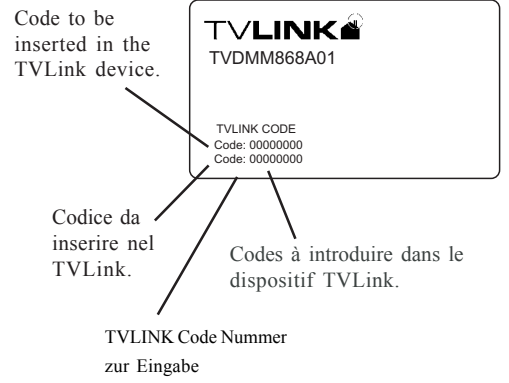
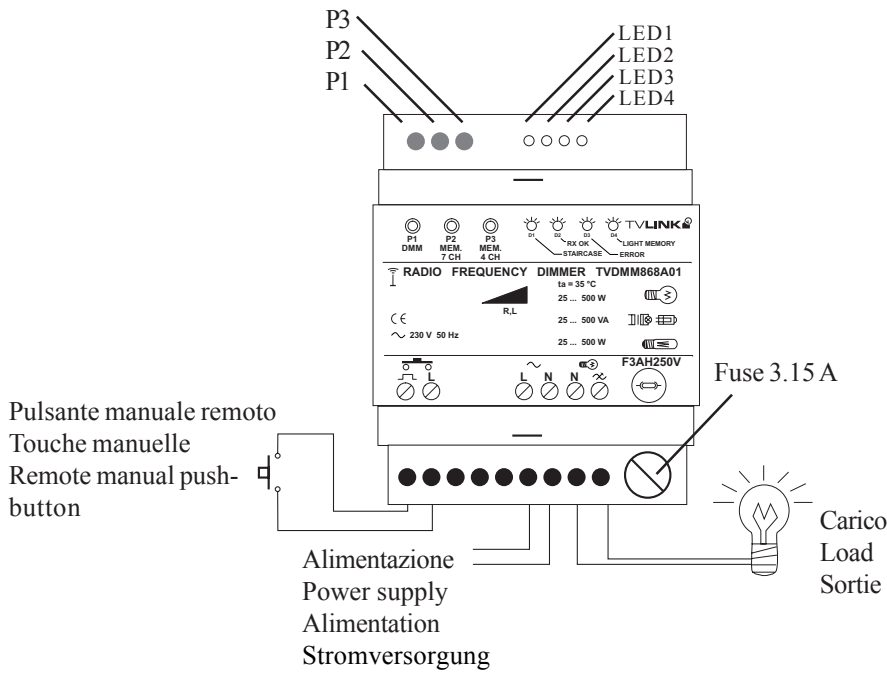

**TVTXC868A07**  
(Use only for scenes  
Utilizzare solo per scenari  
Utiliser seulement pour scènes)

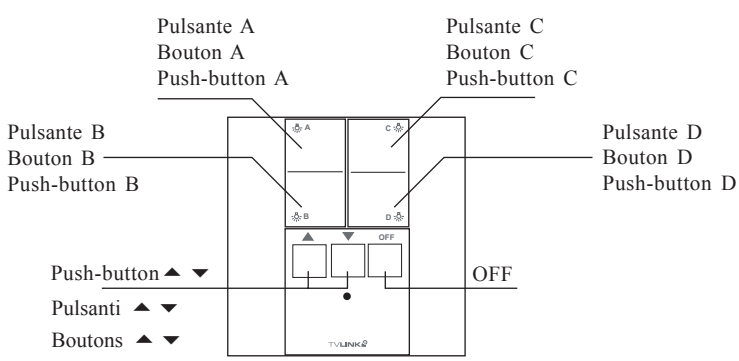

**TVTXC868A04**

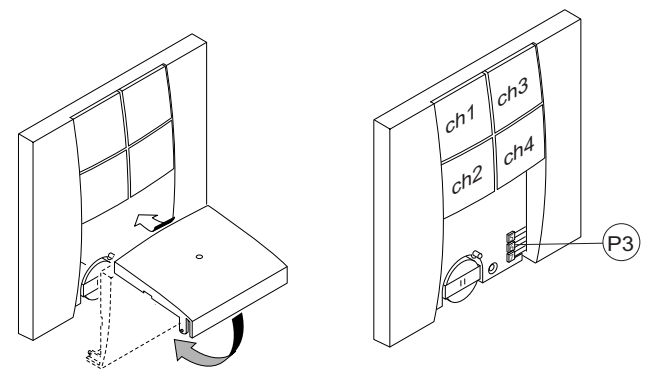

**TVTXP868A01/02/04**

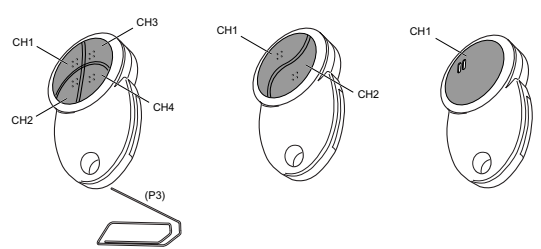

**TVTXV868A01/02/04**

