

ASSEMBLING INSTRUCTION (FIG. 1)

Unscrew the closing screws **A**
Take out the cover **B**
Unscrew the screw **C** of the cord anchorage **D**
Strip the cable to be connected respecting the quotes indicated
Connect supply cable to the terminals **L**, **N** and \oplus of the electronic card
Connect lamp cable to the terminal identified by symbol \otimes and \oplus of the electronic card
Mount cord anchorage **D** using the screw **C**
(Beware: position cord anchorage **D** as showed, according to the type of cable, flat or round, to be connected).
Mount cover **B**, screwing the screws **A**

USE INSTRUCTION



ON and OFF: through switch **E**
At ON, in order to help ignition of the lamp, it goes to the max. dimming value, after that it reaches latest memorized value
MIN. and MAX.: Through potentiometer (Slider) **F**
Memorization of the latest setting made.
It keeps the memory of last dimming, even in case of switching-off from a controlled electrical socket.
In case of overcurrent protection intervention, disconnect the voltage from the dimmer to restore it.

SHUT OFF VOLTAGE BEFORE REPLACING THE
FUSE T2.5A H 250V
OPERATION TO BE MADE EXCLUSIVELY BY
SPECIALIZED TECHNICAL PERSONNEL





ELECTRONIC LIGHT DIMMER

1012AS Lamp LFP - 1012S Lamp LFP



15
UL
CERTIFIED
E-66137
E-66137
SWITCH IEC 61058-1

100-240V a.c. 50/60Hz
4W-250W (@220-240V) 4W-200W (@120V) 
11W-25W CFL Dimmable Max. 4x
4W-25W LED Dimmable Max. 4x



Artt. 1012S Lamp LFP H03VVH2-F 2x0.75mm2 H03VV-F 2x / 3G 0.75mm2 H03V2V2H2-F 2x0.75mm2 H03V2V2-F 2x / 3G 0.75mm2 SPT-2 18AWG 2cores (USA) NISPT-2 18AWG 2cores (USA) SVT 18AWG 2/3cores (USA)	Artt. 1012AS Lamp LFP FRDR 2x0.75mm2 FROR 2x0.75mm2 FR5FDR 2x0.75mm2 FR5FOR 2x0.75mm2 SPT-2 18AWG 2cores (USA) NISPT-2 18AWG 2cores (USA) SVT 18AWG 2/3cores (USA)
---	--

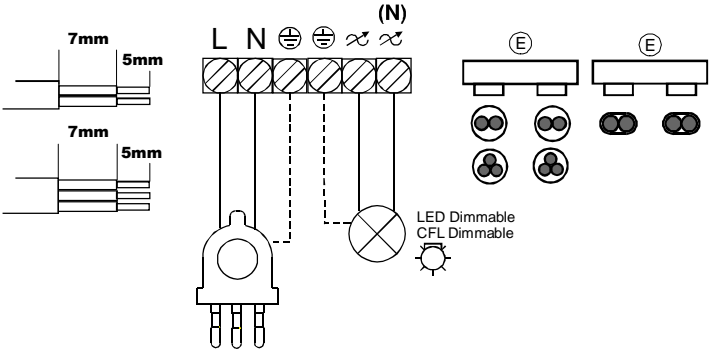

Pollution Degree: 2
Protection Degree IP: 20
Resistance index to surface current: PT1175V
Glow wire test level: 1 (650°C) ϵ
Fuse incorporated: replaceable
No. of cycles: 10000
Type of disconnection: Electronic
Type of Duty: Continuous S1

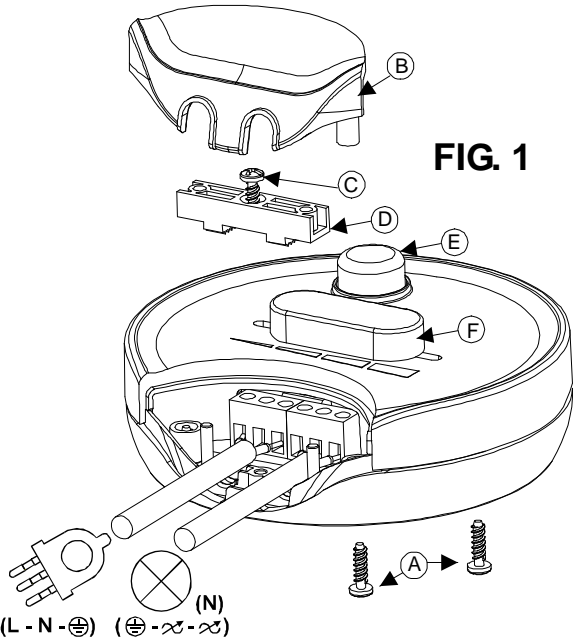

The presence of this symbol on product or its packaging means that the product should not be disposed of with your other household waste.